

# Specification

		SA1600/600			SA 2000/770			SA 2500/1000			SA 2800/1350		
		A	B	C	A	B	C	A	B	C	A	B	C
<b>INJECTION UNIT</b>													
Screw diameter	mm	40	45	50	45	50	55	50	55	60	55	60	65
Screw L/D ratio	L/D	22.5	20	18	22.2	20	18.2	22	20	18.3	21.8	20	18.5
Shot size (theoretical)	cm <sup>3</sup>	253	320	395	334	412	499	471	570	679	618	735	863
Injection weight (PS)	g	230	291	359	304	375	454	429	519	618	562	669	785
Injection rate (PS)	g/s	135	171	211	191	235	285	205	248	295	270	321	377
Plasticizing rate (PS)	g/s	15.4	20	24	20	24	29.6	24	29.6	33.7	29.6	33.7	38.2
Injection pressure	MPa	238	188	152	231	187	155	215	178	149	219	184	157
Screw speed	rpm		0~255			0~255			0~225			0~270	
<b>CLAMPING UNIT</b>													
Clamp tonnage	kN		1600			2000			2500			2800	
Toggle stroke	mm		430			490			540			590	
Space between tie bars	mm		470 x 470			530 x 530			580 x 580			630 x 630	
Max. mold height	mm		520			550			580			630	
Min. mold height	mm		180			200			220			230	
Ejector stroke	mm		140			140			150			150	
Ejector force	kN		33			62			62			62	
Ejector number	pcs		5			9			9			13	
<b>OTHERS</b>													
Max. pump pressure	MPa		16			16			16			16	
Pump motor power	kW		22			30			30			37	
Heater power	kW		9.75			14.25			16.65			17.85	
Machine dimension (l x w x h)	m		5.15 x 1.35 x 1.96			5.45 x 1.58 x 2.04			6.09 x 1.67 x 2.09			6.43 x 1.83 x 2.08	
Machine weight	t		5.3			6.9			8.3			11	
Hopper capacity	kg		25			50			50			50	
Oil tank capacity	l		350			420			555			705	

**Platen dimensions**  
Moving platen

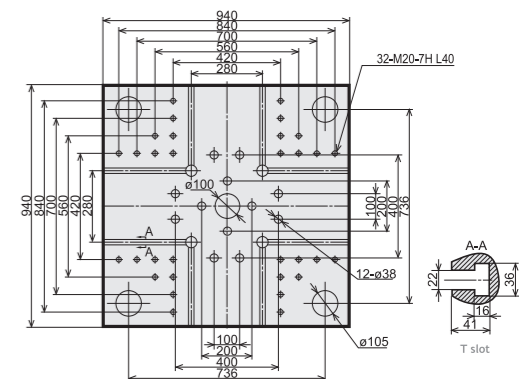
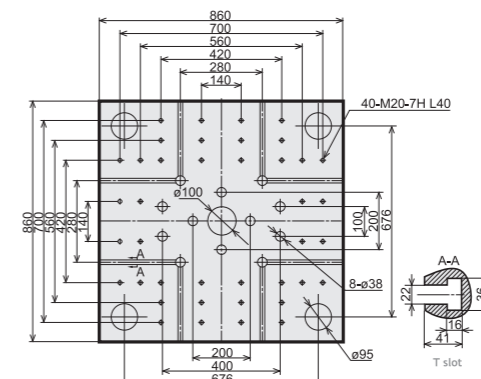
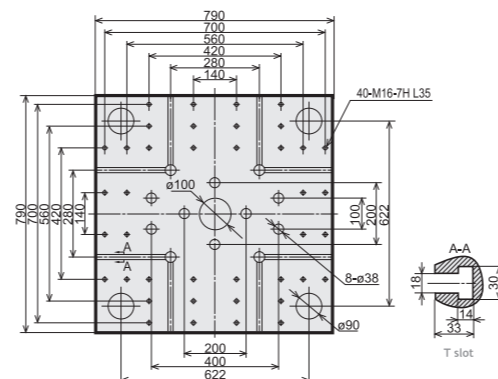
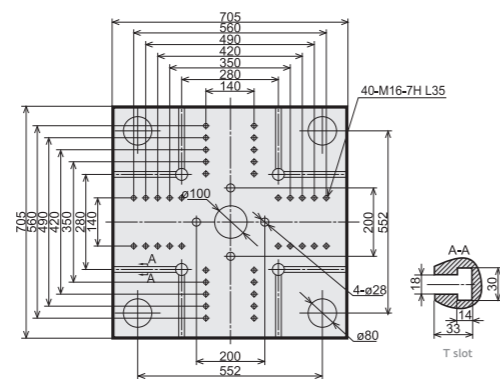

**Platen dimensions**

Mounting hole for robot/sprue picker top view from fixed platen

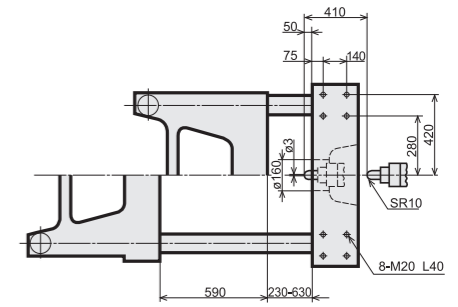
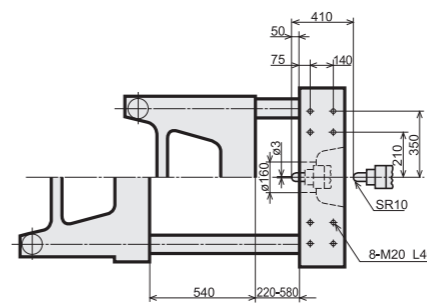
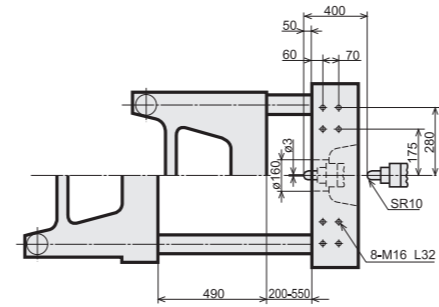
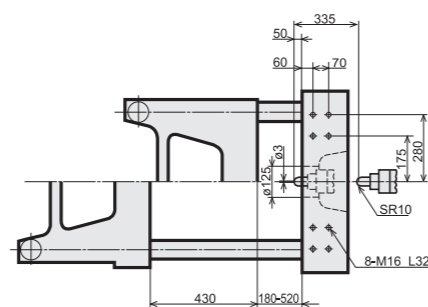

**Machine dimensions**

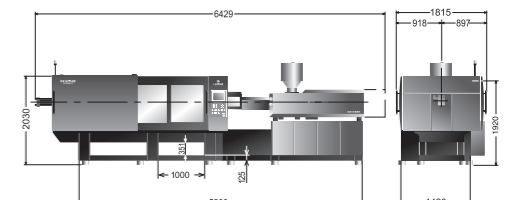
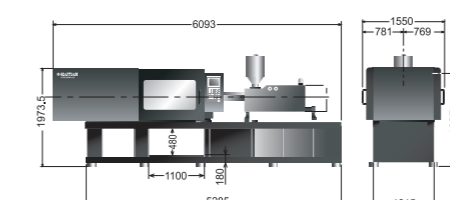
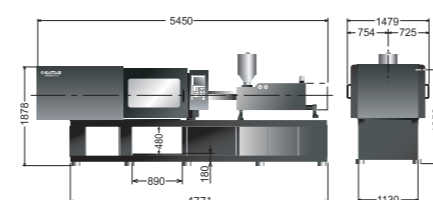
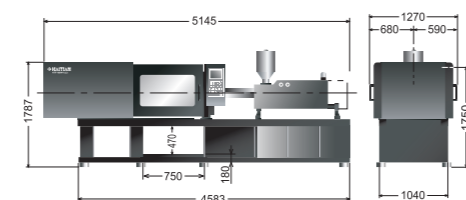

We reserve the right to make changes as a result of further technical advantages.

\* Depend on injection size